

*Maximart*®  
CE / EMC ISO 9001

# VALIANter VMC

PERFORMANCE • RELIABILITY • PRECISION

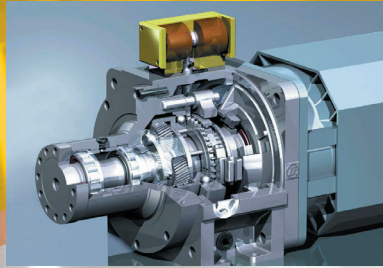



ZF/Germany 2-speed gearbox for AC spindle motor, increases spindle torque output to 4 times as without it, with independent oil cooling system incorporated. This optional equipment is available for all models of spindle speed up to 10000rpm.

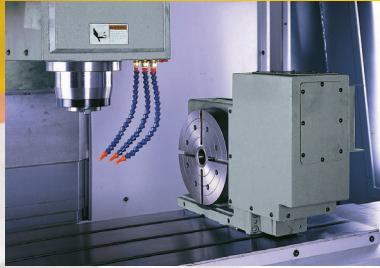

The 4<sup>th</sup> axis package, as an optional equipment, including PLC & AC servo driver and motor together with wirings & connectors prepared.

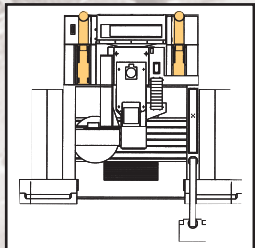

Two sides Screw-drive chip conveyor is standard equipment, chips outlet at backside of machine. No chips flood flushing needed.

# VMC-135E

## iTNC-530 HSCI

- WORK TABLE : 1500mm x 700mm
- X/Y/Z TRAVEL : 1350mm x 760mm x 710mm
- A.T.C. : ARMLESS TYPE 20 TOOLS
- FLOOR SPACE : D 4500mm x W 5210mm x H 2830mm
- MACHINE WEIGHT : 7200kgs



# VMC-105E

## FANUC Oi - MD

- WORK TABLE : 1250mm x 515mm
- X/Y/Z TRAVEL : 1050mm x 560mm x 520mm
- A.T.C. : ARMLESS TYPE 20 TOOLS
- FLOOR SPACE : D 3950mm x W 4400mm x H 2520mm
- MACHINE WEIGHT : 4800kgs

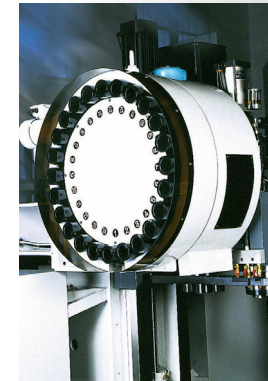

Optional Arm type auto tool changing system, combination of a double-arm A.T.C. mechanism and a 24 tools magazine.

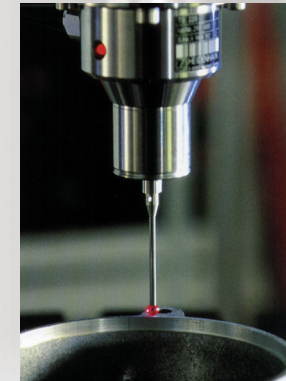

Optional 3-D touch probe for workpiece alignment and workpiece measurement.

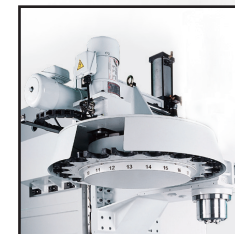

Inverter drive 20 tools armless ATC system. Side-opening for loading tools, auto-closed magazine cover during machining.

# VMC-65S

## TNC-620 NEW

- WORK TABLE : 850mm x 425mm
- X/Y/Z TRAVEL : 650mm x 500mm x 500mm
- A.T.C. : ARMLESS TYPE 20 TOOLS
- FLOOR SPACE : D 3700mm x W 3530mm x H 2520mm
- MACHINE WEIGHT : 3800kgs

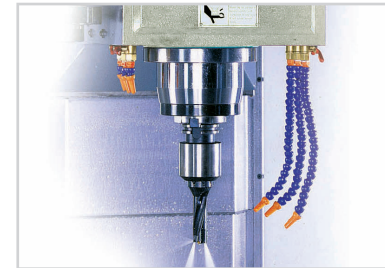

**Optional** Coolant thru spindle" available on all models. This system incorporates "GROUNDFOSS"/ Demark high pressure pump on a centrifugal cleaner coolant tank for 22 bar unit (a high pressure filter for 8 bar), which provides clean & high pressure coolant, flushing thru spindle / cutting tool directly into workpiece thru-out whole machining process.

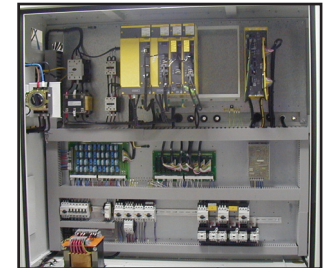

Clean & neat electrical cabinet, all wirings & circuits are conform to international electrical codes and **Optional** CE/EMC safety regulations.

# Quality Controls & Inspections



"H.P." laser calibration system ensure machine accuracy & repetition.

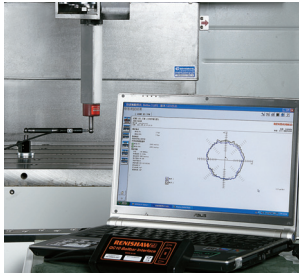

"Heidenhain" double ball bar system, circular test ensuring machine tool geometry.



Constant inspection thru-out assemble/ production floor.

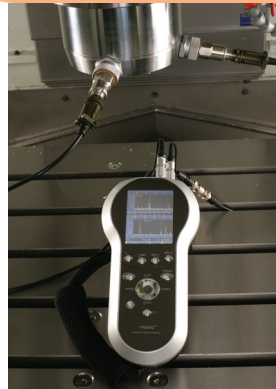

4-channel dynamic signal analyzer. To inspect & analyze spindle vibration and make sure spindle running at perfect conditions.

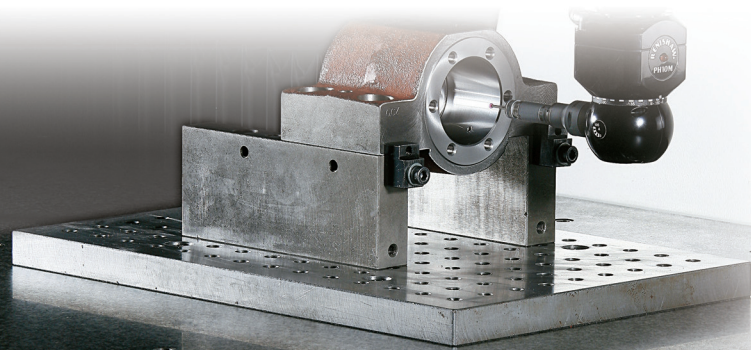

3-D measuring equipments assure all parts are within accuracy.

**WENZEL**<sup>®</sup>  
The company of  $\mu$

## Dynamic Balance Calibration for Spindle Motor

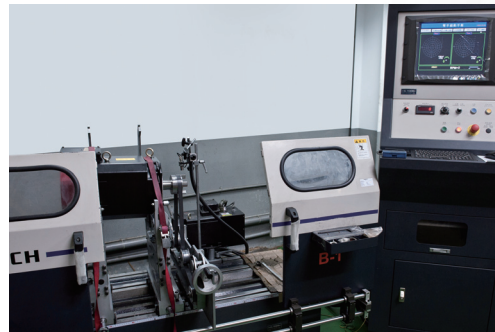

Each spindle motor is subject to dynamic balance calibration before it is assembled to the machine, with the dynamic balance calibration minimized spindle motor chattering and higher machining accuracy can be achieved.

## CNC CONTROLLER:



**FANUC**

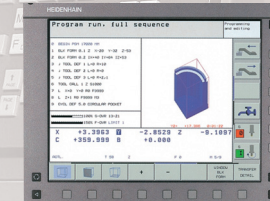

**HEIDENHAIN**



**MITSUBISHI**

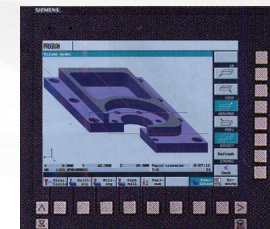

**SIEMENS**

# DIMENSIONS:

(unit:mm)

## VMC-65S, VMC-105E

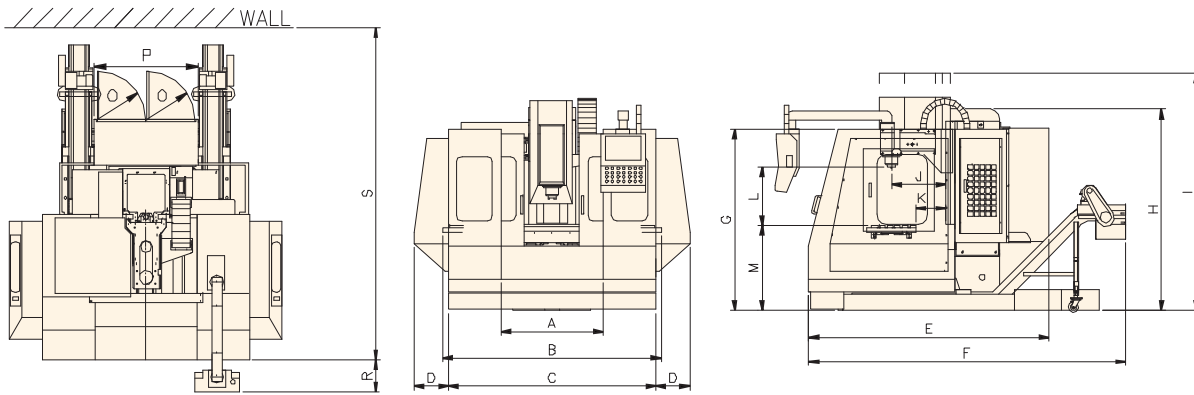

MODEL	A	B	C	D	E	F	G	H	I	J	K	L	M	N	O	P	R	S
VMC-65S	930	1500	2230	-	2490	3180	1995	2120	2520	510	35~535	132~632	940	515	1100	340	650	3050
VMC-105E	1080	2300	2900	360	2530	3340	2140			580	42.5~602.5	157~677	895				750	3200

## VMC-135E

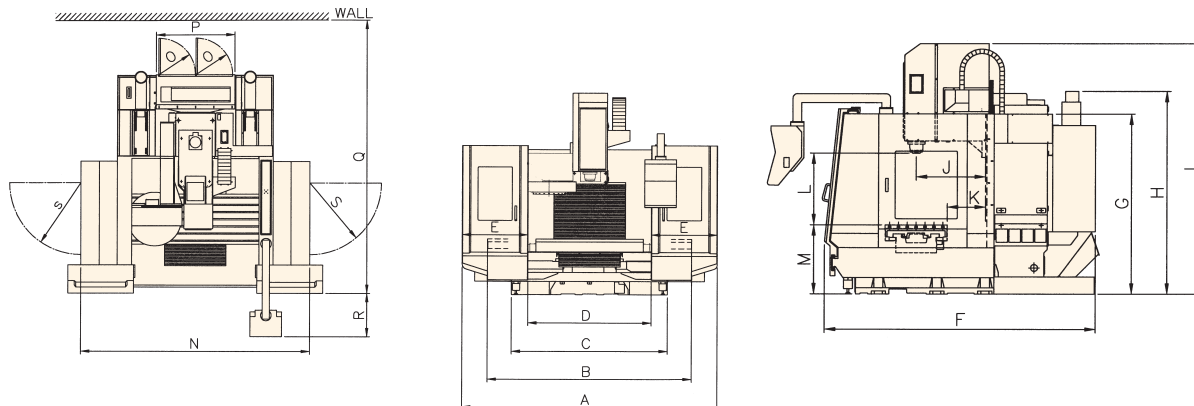

MODEL	A	B	C	D	E	F	G	H	I	J	K	L	M	N	O	P	Q	R	S
VMC-135E	3540	3000	2180	1700	920	3050	1990	2290	2830	780	50~810	100~810	780	3210	515	1100	3800	700	1000

# TOOLING

(unit:mm)

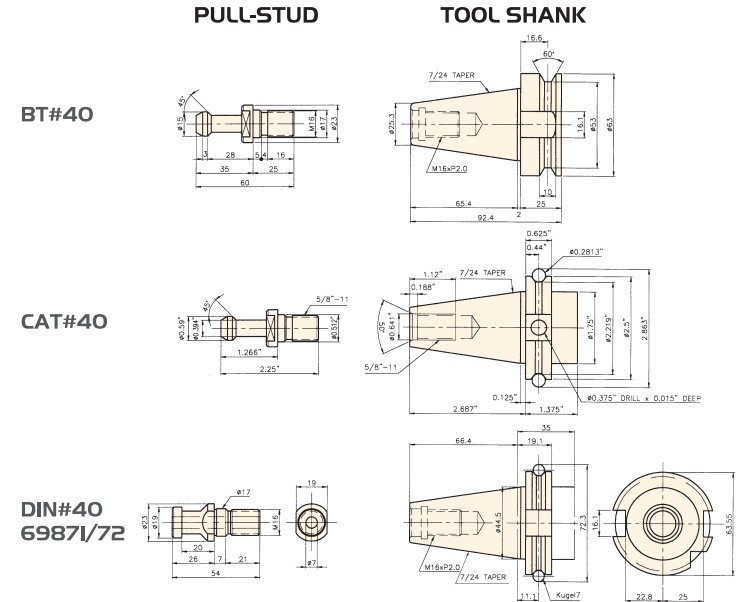

# TABLES AND TOOL-HOLDERS: (unit:mm)

TABLE  
VMC-135E

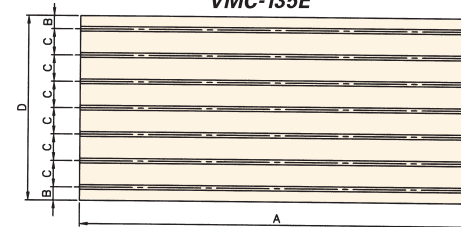

T-SLOTS

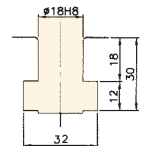

MODEL	A	B	C	D
VMC-135E	1500	50	100	700

TABLE  
VMC-105E

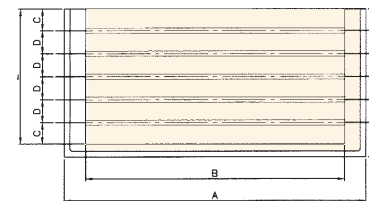
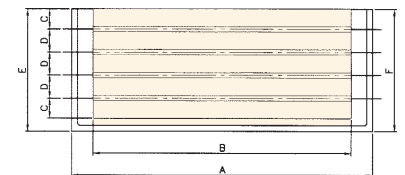

TABLE  
VMC-65S



MODEL	A	B	C	D	E	F
VMC-105E	1250	1100	75	80	470	515
VMC-65S	850	700	70	80	380	425

## Machine Specifications

ITEM/MODEL	VMC-65S	VMC-105E	VMC-135E
<b>WORK TABLE</b>			
Table size	850mm x 425mm	1250mm x 515mm	1500mm x 700mm
T-slot (width x nr. x dis.) Precisely ground	18mm x 4 x 80mm	18mm x 5 x 80mm	18mm x 7 x 100mm
Table load capacity	450kgs.	800kgs.	1200kgs.
<b>MOVEMENT &amp; RANGE</b>			
X.Y.Z. Axis travel	650mm x 500mm x 500mm	1050mm x 560mm x 520mm	1350mm x 760mm x 710mm
Positioning accuracy	0.003mm/300mm	0.003mm/300mm	0.003mm/300mm
Repeti ion X.Y.Z. Axis	± 0.003mm	± 0.003mm	± 0.003mm
Spindle nose to work table	132-632mm	157-677mm	100-810mm
Spindle center to column	510mm	580mm	780mm
<b>SPINDLE</b>			
Spindle nose	BT#40 (CAT#40/DIN#40. 69871. 69872)		
Spindle speed	60-8000rpm Belt-drive spindle without spindle cooler (OPT. 60-10000rpm)		
Change of speeds	AC spindle motor, infinitely variable.		
Coolant thru spindle	Optional, available 8 bars/22 bars.		
Spindle Dia.	ø70mm	ø70mm	ø70mm
<b>FEEDS</b>			
Feed rate (mm/min.)	1-5000mm/min	1-5000mm/min	1-5000mm/min
Rapid traverse (m/min.)	X/Y=15M/min, Z=12M/min	X/Y=15M/min, Z=12M/min	X/Y=15M/min, Z=12M/min
<b>A.T.C.</b>			
Tool storage capacity	20 Tools armless type ATC. (OPT. 24 tools For VMC-65S/105E, 30 tools For VMC-135E)		
Max. tool dia.	ø100mm	ø100mm	ø100mm
Tool selection	BI-Direction random, shortest path		
Max. tool weight	7kgs/pc	7kgs/pc	7kgs/pc
<b>DRIVE MOTORS</b>			
AC spindle motor (30min/cont)	7.5/5.5Kw-12/9kw, depend on CNC/AC servo system selected		16/11kw-11/7.0kw
X.Y.Z. Ac servo motor	1.0Kw-3.5Kw, depend on CNC/AC servo system selected		2kw~3.6kw
Coolant motor	TPHK 4T3-3	TPHK 4T3-3	TPHK 4T3-3
Chip conveyor motor	1/4HP	1/4HP	1/4HP
<b>MACHINE WEIGHT</b>	3800kgs.	4800kgs.	7200kgs.

- Above specifications are subject to change without prior notice.

## STANDARD ACCESSORIES:

- FULL ENCLOSURE MACHINE GUARDING INCLUDES:
  - \* FULL ENCLOSURE MACHINE GUARD.
  - \* 2 SIDES SCREW-DRIVE TYPE CHIP CONVEYOR.
  - \* ONE PIECE AIR GUN & ONE PIECE COOLANT SPRAYER INSTALLED OUTSIDE MACHINE GUARD.
- AUTO LUBE SYSTEM WITH ALARM.
- COOLANT SYSTEM.
- HALOGEN WORK LIGHT.
- 20 TOOLS ARMLESS TYPE ATC SYSTEM.
- AUTO POWER OFF.
- SPINDLE AIR BLAST AND CHIPS AIR BLAST.
- RIGID TAPPING.
- COOLING FANS FOR ELECTRICAL CABINET.
- TOOLS & TOOL BOX.
- MACHINE LEVELLING BOLTS & PADS.
- OPERATION MANUALS & PARTS LIST MANUAL.

## OPTIONAL ACCESSORIES:

- CE/EMC CONFORMITY MACHINE
- TRANSFORMER FOR CNC SYSTEM TO SUIT LOCAL VOLTAGE.
- 24 TOOLS FOR VMC-65S / 105E  
30 TOOLS FOR VMC-135E
- 1.5 SECONDS (TOOL TO TOOL) QUICK TOOL-CHANGING SYSTEM, FOR ARM TYPE ATC ONLY.
- COOLANT THROUGH SPINDLE
  - a. 22 BARS PACKAGE.
  - b. 8 BARS PACKAGE.
- COOLANT/OIL SKIMMER.
- 4TH AXIS AC SERVO PACKAGE PREPARED.
- CNC ROTARY TABLE and/or TAILSTOCK.
- ZF 2-SPEED GEARBOX FOR AC SPINDLE MOTOR.
- 10000rpm SPINDLE SPEED WITH SPINDLE COOLING SYSTEM.
- DIN #40 SPINDLE TAPER.
- CNC SYSTEM OVERSEAS WARRANTY.

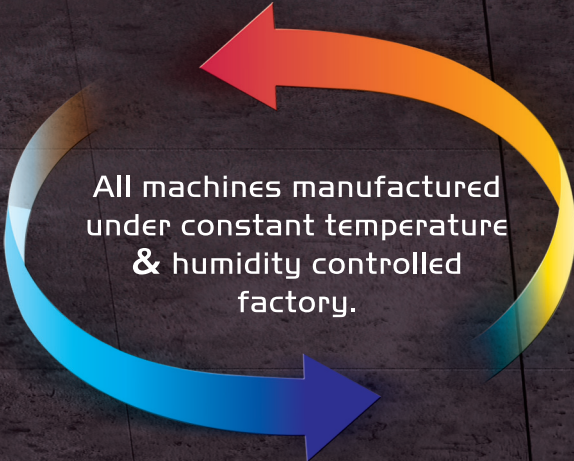

All machines manufactured  
under constant temperature  
& humidity controlled  
factory.

**HIGH PRECISION HIGH ACCURACY GUARANTEED**



**MAXIMART CORPORATION**

TEL: 886-2-2531-4161 FAX: 886-2-2563-4936

<http://www.maximart.com.tw> E-mail: [maximart.tw@gmail.com](mailto:maximart.tw@gmail.com)